

FLOOR REGISTERS

Installation Instructions



CAUTION: Improper installation will result in poor product performance.

- Do not over tighten or angle screws during installation.
- The design of this product is intended for secure attachment to flooring without flexing.
- This product is plastic and will NOT install in the same manner as a metal product. Not following instructions could result in excess flexing and deformation which results in cracking. Additional care during installation must be taken.
- Failure to follow these instructions for installation of our product will forfeit any warranty consideration.



SMOOTH FLOORING (Vinyl, Ceramic, Hardwood)

- Hole cut-out must be no larger than 1/16" on each side of the inserted flange.
- Cut-out dimension is 2-3/8" x 10".
- Secure product into opening using correct screws. (Flat head screws are recommended.)

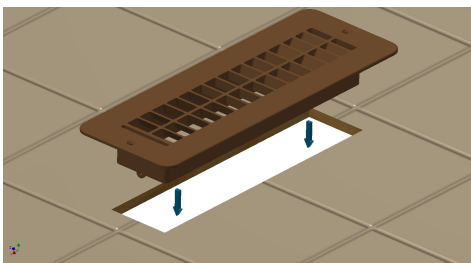

CARPETED FLOORING

- Hole cut-out must be no larger than 1/16" on each side of the inserted flange.
- Cut-out dimension is 2-3/8" x 10".
- Cut back the padding a minimum of 2" on each side of cut-out dimension and secure register to the floor. This eliminates the "give" of the padding and allows the register to draw down to the floor.
- Failure to cut padding will cause the register to lift and "flex up" and become a tripping hazard.
- Secure product into opening using correct screws. (Flat head screws are recommended.)

